



This equipment is not designed for making emergency telephone calls when the power fails. Alternative arrangements should be made for access to emergency services.
This product is intended for connection to analogue public switched telephone networks and private switchboards in the United Kingdom.

Diverse 4016 Executive
Digital Cordless Telephone Answering Machine

**User
Guide**

File Name: Bt diverse 4016 executive manual.pdf
Size: 4053 KB
Type: PDF, ePub, eBook
Category: Book
Uploaded: 19 May 2019, 20:19 PM
Rating: 4.6/5 from 745 votes.

Download Now!

Please check the box below to proceed.



I'm not a robot



reCAPTCHA
[Privacy](#) - [Terms](#)

Book Descriptions:

Bt diverse 4016 executive manual



Lets you select from the menu options shown in Navigation button the display. After selecting an entry, and pressing the button, the following functions are available. Press to get your messages from the mailbox, answering machine, message list and text messages. The following functions are available If you make a mistake, you can return to the previous menu by pressing the button. For guarantee purposes proof of One Diverse 4016 purchase is required so please keep Executive base station your receipt. Enter your system PIN code here. Using an station with a damp not wet cloth, or unauthorised power supply will an antistatic wipe. Never use household invalidate your guarantee and may polish as this will damage the product. The Diverse 4016 handset will be easily registered once you complete the steps 1 to 3 below. Situate your product close enough to the telephone and mains power sockets so that the cables will reach. The battery cover may be found in the packaging with the batteries. Leave the handset for approx. 16 hours. However, by simply switching obtained from any BT shop or from the handset OFF for a moment, then the Diverse Helpline ON again, it will find the base station If you replace the handset batteries within a few seconds. Press the navigation button until the display shows Your Diverse 4016 Executive is now ready for use. However, If you experience Press the options button.Press the navigation button. If you want to keep as 12hr clock. Press the options button if you want to change to 24hr clock. This will take Enter the phone number first.The call is transferred to the loudspeaker. Press the options button. Enter the telephone number. Press the navigation button to enter the name. Enter the name. Entering names During a call you can switch to Enter the name using the letters. Letters are always added to the left of the cursor. Press to switch between capitals and lower case.<http://ctescoa.com/userfiles/dawn-of-war-dark-crusade-manual-patch.xml>

- **bt diverse 4016 executive manual, bt diverse 4016 executive manual pdf, bt diverse 4016 executive manual download, bt diverse 4016 executive manual free, bt diverse 4016 executive manual 2016.**



Press to move the cursor Press to delete from left to right, Press to enter a blank space. Press the navigation button to scroll to the entry Enter the first letter of the you want.The entry is copied. You can now repeat these steps until you have copied all the entries You can copy individual you want.Press the navigation The receiving handset displays button to open the directory.Any entries with the button to scroll to the entry same number are duplicated you want to delete. You can see how much directory memory is still unused. Press the navigation button to open the directory. Press the navigation Press the options button to highlight the first button.Press the navigation Press the. You can alert handset users that they are wanted, or locate a missing handset. If you have multiple handsets Press the options registered to the base you can make. During an external call Press the navigation During a call button to display the list of Press the navigation. Your handset display shows the line is In Use. Press the Press the navigation button, the other two callers button until the display shows. For more Calls list, as there is no telephone information on BT's Select Services number sent via the Network.Press the button. Press the navigation button until the display shows Total number of new calls Press the options button. The most recently received Serial number of call is displayed. Press the options button. The most recently received The most recently received call is displayed.Press the options button. The most recently received The most recently received call is shown on the display.Service, when you are on a call and another person tries to call you, the second caller's number will appear on the handset display and you will hear an intermittent beep through the. Press the options button. Enter the telephone number Call Divert requires subscription you want your calls diverted to.You Press the options button.Display shows Press the options button.<http://fxwuye.com/upload/dawn-of-war-manual-update.xml>



This equipment is not designed for making emergency telephone calls when the power fails. Alternative arrangements should be made for access to emergency services.

This product is intended for connection to analogue public switched telephone networks and private switchboards in the United Kingdom.

Diverse 4016 Executive

Digital Cordless Telephone Answering Machine

User Guide

Enter the time you want the alarm to be set for. Press the navigation button. You can now choose the You can use your handset as ringer melody for your alarm call. Press the You have set the alarm but do navigation button to select not want it to ring every day. Press the navigation Press the navigation button to move to the next line. Press the options button to If you miss an appointment or return to the list. If a certain noise level is reached, the Press the options button. Press the options button. Press the options button Press the navigation to save the number. Press the options When you are called by the button to enter the number. The melody is played and its Press the options button. Press the options button. Press the navigation Press the navigation button until the display shows button until the display shows Press the options button. Press the Press the navigation. Registration, the Directory This is called autotalk. When and the Calls list are not you switch autotalk off, you affected. You can stop individual will appear next to your handsets from dialling specific selection. Repeat the new PIN to confirm. Your base station PIN has a default Press the options button setting of but you may want to to save the new PIN. Enter the PIN original setting You can restore a base station to its factory settings. Resetting Press the options button. This boosts the signal and allows you to use your handset further away from the base station. If you want to use a Diverse repeater, you must switch this mode on. Please leave your message Press the options button. You Press the navigation can always go back to the prerecorded. When you have selected what If you pause during recording for type of outgoing message you longer than 2 seconds, recording is want stopped. Press the navigation button until the display shows If the answering machine memory. Press the options button.

Put the handset to your ear You will hear a confirmation and you will hear the message tone and the display shows played back. From your handset, you can listen into The machine stops recording a caller leaving their message. This and you can talk to your caller. The factory setting is on. Press the options button. However, you can play a message and then make it a Put the handset to your ear new unplayed message again. If you have more than one handset registered to the base station and the You can record a memo that answering machine is switched on,. This allows you to make internal calls between two If you purchase new handsets to use with handsets while a third is making an your current Diverse 4016 Executive, external call. Press the options button. You can

change the internal handset Enter the base station PIN number if you wish, see page 44. Register your handset Press the options button. Press the options button. Press the navigation button until the display shows Press the options button. You can change extension telephones, each with a REN the dial mode to pulse dialling. Diverse 4016 you can switch to Press the navigation tone dialling during the call. Press the button. Press the button. Registered Office 81 Newgate Street, London EC1A 7AJ. Siemens number A31008G4015P10227619. Alternative arrangements should be made for access to emergency services. This product is intended for connection to analogue public switched telephone networks and private switchboards in the United Kingdom. The Art of Communication Were committed to dealing with such abuse according to the laws in your country of residence. When you submit a report, well investigate it and take the appropriate action. Well get back to you only if we require additional details or have more information to share. Note that email addresses and full names are not considered private information. Please mention this; Therefore, avoid filling in personal details. The manual is 2,08 mb in size.

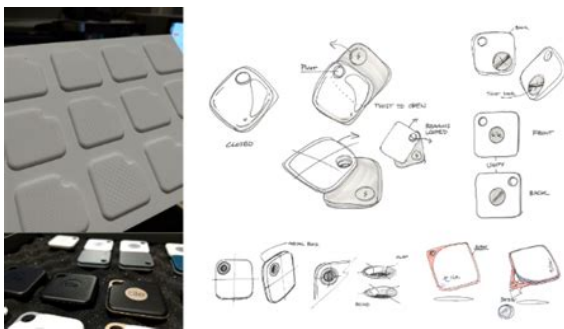

<http://www.drupalitalia.org/node/70669>

If you have not received an email, then probably have entered the wrong email address or your mailbox is too full. In addition, it may be that your ISP may have a maximum size for emails to receive. Check your email Please enter your email address. This product is intended for connection to analogue public switched telephone networksDiverse 4016 Classic. Digital Cordless Telephone Answering Machine. User. GuideAt a glance. In use light. Display. Lights up to indicate anDisplays the status ofOption buttons. The light also flashes toLets you select fromLeft hand side. Right hand side. To access list of internalTakes you intoLeft hand side. Takes you intoTakes you into theDirectory. Used to store andRed phoneOne button. Apart from being theNetwork Services. MicrophoneFor making andSwitches the keypadExtra Directory. Used to storeHandset display. When in MENU modePress the left side of theDisplay option buttons. The OPTION buttons allowBase. Base underside. Telephone line cord socket. Power socket. Contact pointsIn this guide. At a glance. Menu structureQuick guide to handsetIntroduction. Unpacking your. Diverse 4016 Classic. For your records. Safety information. Setting up. Registering and chargingUsing the telephone. Making and ending calls. Call timer. Name and number directory. Extra directory. Redial. Secrecy. Paging and internal calls. Alarm clock. Caller Display andCaller Display. Calls list. Call Waiting. Call Divert. Withhold number. Ring BackKeyguardBase Station PIN Personal. Identification NumberCall screening. New message indicator. Playing messages. Additional answeringRemote accessGeneral information. Guarantee. Technical information. Switchboard compatibility. Setting pauses. IndexIf you experience any dif ficultiesHints and tips boxes. In this user guide, we've includedThey are shown in boxes like this.Sel Services. Withhold No. Ringback Off. Alarm Clock. Audio Set. Base Set. Enter alarm call timeRingerMelodyAudio Set up.

<http://chaletvictorhugo.com/images/bosch-router-instruction-manual.pdf>



NILES®



INSTALLATION GUIDE



HOLE COVERS FOR CM SERIES LOUDSPEAKERS

CM SERIES HOLE COVERS

Speaker VolRinger VolMelodyDate Set. Clock Set. Clock ModeBase ResetAdd Features. Dial Mode. Tone. PulseBarge In. Voice Mail. Set key 1. Ans Machine. Mailbox. Announcement. Rec Anc. Play Anc. Del Anc. Message Set. Msg LengthQuality. Long Play. High Quality. Call Screen. Ring DelayOpen directory. Open extra directory. Edit entry. New entry. Show entry. Delete. Open redial list. Copy to dirPress OK to open list. DeletePress OK to open list. Copy To DirTime. Status. Delete List. List Mode. Missed. AllPHONE button. If you keep pressing the RED PHONE button you will return to thePageCommonly used handset functions and settings. Hold downHold downRedial a number. To store a name andCommonly used answering machine functions and settings. PageSwitch answering machineHold downHold downHold downHold downDelete outgoing messageRedial, lists up to the last 5 dialled number. Flashes to indicate new messages or missed calls. For calling other handsets. Opens the menu. Shows the status of the handset battery. Scroll through the menu. Confirms the function displayed. Scroll left and right when entering numbers or messages. Handset locked. Displayed when the Alarm clock is set.Shows the number of the handset and is displayed in top left hand corner. Indicates that the answering machine is on. Helpline. If you experience any difficulties with your Diverse 4016 Classic, please call the. BT Diverse Helpline on 08457 908 070.Unpacking your. If anything is missing, please contactFor guarantee purposes proof ofOne Diverse 4016. Classic base station. One Diverse 4000. Classic handset. Date of purchase. Enter your base station PIN code hereFor more information on your base PINHelpline. One telephoneTwo AA rechargeableOne belt clip. BatterySafety information. General. Only use the power supply includedPower supplyIf the Keyguard is switched on, it is. NOT possible to make calls, including.

<http://chamabusinesscenter.com/images/bosch-router-pof-500a-manual.pdf>

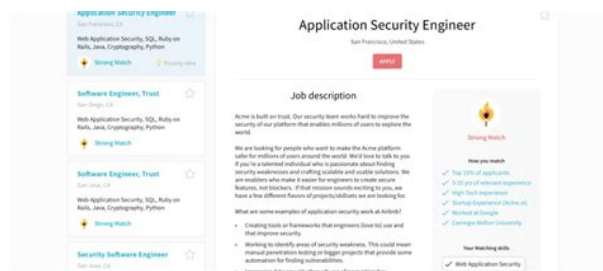

Do not open the base station or handset. Radio signals transmitted between the handset and base station should not be used near environmental. Do not expose to direct sunlight. The product may heat up when the batteries are available from the diverse. Helpline 08457 908070. Cleaning. Simply clean the handset and base. Never use a dry cloth as this may cause damage. Do not stand your product on carpets or do not submerge any part of your product. Do not expose your product to fire. There is a slight chance that your phone will be easily damaged. We recommend that you unplug the handset. Never dispose of batteries in a fire. There is a slight chance that your handset will be easily damaged. Plan the location. Make sure it is at least 1 metre away. Do not situate the product in the answering machine before the battery. Plug the power supply cable into the handset. The display is protected by a plastic insert. Insert the batteries. When the handset is registered, insert the two batteries supplied. If the icons on the display, it means that the handset is not correctly carried out. Only use the approved batteries please. To register your handset, place it in the handset. All additional handsets you purchase. Leave the handset for approx. 16 hours. Helpline. If you experience any difficulties. Battery performance. When the batteries are almost flat, after charging your handset batteries. Batteries and case may become warm. Batteries fully charged. Batteries at 66%. Batteries at 33%. Batteries empty. Out of range. ON again, it will find the base station. Fully discharging the batteries at least. If you replace the handset batteries. Setting the date and time. Press the MENU options. Press the DOWN button until. Press the DOWN button until. Fit the belt clip onto the back of. Press the OK button. The display will show DATE SET. Use the keypad to enter the date. Press the DOWN button until. Use the keypad to enter the time. Helpline. Your Diverse 4016 Classic is now ready. Press the DOWN button to. Press the RED PHONE button. If you subscribe to a Caller Display.

Service the time and date will be set. To set the time mode. The handset's default setting is. Press the DOWN button until. Press the DOWN button until. Press the DOWN button until. Press the UP or DOWN button. H settings. Press the RED PHONE button. Your Diverse 4016 Classic has a menu. Note. To switch the handset power. Press and hold the RED. PHONE button to switch the handset. Press and hold the RED. PHONE button to switch the handset. To make an external call. Ensure the handset is charged. Press the GREEN PHONE button. Dial the number. RED PHONE button. This will take you back to the handset. Making and ending calls. Preparatory dialling. Enter the phone number first. If you make a mistake, press the GREEN PHONE button. To end a call. Press the RED PHONE button. Your handset automatically times the call. To receive an external call. When the phone rings, the handset will show the name and number in the directory. You can store up to 20 of your most used numbers. To store a name and number in the directory. Press the DIRECTORY button. Or you do not need to press the. GREEN PHONE button. Press the DOWN button until. Enter the telephone number. Entering names. This is called autodial. You can enter the name using the keypad. For example, to enter the name. Press OK to confirm. The display will show SAVED. Press the GREEN PHONE button. To edit a directory entry. Or. Press the RED PHONE button. Character map. As well as the standard letters and numbers. Press the DIRECTORY button. SHOW ENTRY is displayed. Edit the number. Space. To dial a number from the handset. Press the OK button. The display will show SAVED. You can either press the. GREEN PHONE button to dial. Press the DIRECTORY button. If you wish, you can use the handset. If you experience any difficulties. Press the DOWN button to. Press the GREEN PHONE button. Press the DIRECTORY button. Extra directory. This is an additional directory where you can store names and numbers. Use the DOWN button to find. Press the DOWN button to. The number is deleted. Note. To cancel any procedure, press the. RED PHONE button until the display shows the MENU button.

www.cir.cloud/wp-content/plugins/formcraft/file-upload/server/content/files/1626c1a0447fa8---comp

The structure for this directory You can follow the instructions Note. To delete all entries from the Press the DIRECTORY button. DELETE is displayed. Press the RED PHONE button Caller Display. Enter the name to the number Redial. Your handset automatically saves the To dial a number in the You can dial this number by PHONE button. Press the REDIAL options Press the DOWN button to To delete the redial list. Press the GREEN PHONE Press the REDIAL options Press the MENU options Press the DOWN button until Press the DOWN button until The number is shown on the NAME is displayed. Press the REDIAL options Press OK to confirm. Press the RED PHONE button Note. RED PHONE button until the display Paging and internal calls. When on a call you can talk to someone During a call The call is put on hold and To resume the call Helpline. If you experience any difficulties If you have multiple handsets registered Use the DOWN ARROW on Press the GREEN PHONE If you want to page all the GREEN PHONE button. To transfer an external call To switch 3way conversation. You can transfer an external call Enter the number of the handset The call is transferred and the USE on the display. You can allow your Diverse Press the RED PHONE button Press the OK options button to SAVED is displayed. BARGE IN is Press the OK options button. Or Press the DOWN options Press the DOWN options Press the MENU options Press the RED PHONE button You can talk to one external While another handset user is Press the GREEN PHONE Display shows LISTENING IN. A tone is heard by all three Alarm clock. You can use your handset as an alarm The alarm will To set the alarm Enter the time you want the Press the RED PHONE button Select AM or PM using DOWN Press the RED PHONE button An asterisk appears in front of When the alarm goes off, the. In use light will flash. To stop Press the DOWN button to The alarm is switched off and Press the RED PHONE button To stop the alarm ringing Press any button to switch the Helpline.

[akilciilacdernegi.com/ckfinder/userfiles/files/canadian-lifesaving-manual-price.pdf](#)

If you experience any difficulties Select Services To use Caller Display and Call. Waiting you must first subscribe to the. Services from your Network Provider. For more information on. BT's Select Services call BT free Calls list, as there is no telephone The Calls list contains the telephone If you have stored a name to go with Whether you take a call or not, the Please ensure that you have stored the If the caller has withheld their number, If you call from another handset, the Please note. If you have a new call in your Calls If you subscribe to a Caller Display. Service you can see who is calling you If a call is received when the Calls list is Display the time of the call. To view the Calls list Press the DOWN button to Display the status of the call Press the UP and DOWN When you have found the Call a number from the. When the number you wish to GREEN PHONE button. The number will be dialled Press the OK button. Press the MENU options The date and time of the call To return to the beginning PHONE button repeatedly Press the DOWN button to The display will show the type Press the MENU options Press the DOWN button to Press the RED PHONE button Remember. If you have missed a call the When the number you want to Press the DOWN button to Press the RED PHONE button To set the Calls list to contain Press the ENVELOPE options Enter a name if you wish, see Calls list. When the number you want to DELETE is displayed. Press the OK button. The display shows SAVED. You RED PHONE button until you When any number is displayed, Press the OK button. The display shows NO CALLS. Press the MENU options button. Press the DOWN button to Press the DOWN button to The display shows SAVED. Press the RED PHONE button Helpline. If you experience any difficulties Call Waiting. If you also subscribe to a Call Waiting. Service, when you are on a call and This is to alert you to the other caller You can choose whether to Waiting to interrupt you. Press the OK options button.

Your current call is put on hold Press the RECALL button to Press the DOWN until the During a call when you hear The number or name if stored Press the MENU options button. SEL SERVICES is displayed. Use the UP or DOWN button Listen to your handset for the Press the RED PHONE button You can divert all incoming calls to Enter the phone number Please note. Call Divert requires

subscription from Select your required option You will hear a Network To divert calls Press the OK options button. Use the DOWN arrow on the DIVERT is highlighted. Press the OK options button. You now have a choice of Withhold number. Your number appears on the display of You are able to To withhold your number from Press the OK options button. WITHHOLD NO is displayed. Helpline. Enter the telephone number If you experience any difficulties Press the OK options button, Ring Back To switch Ring Back off if set Press the OK options button. Use the DOWN arrow on the OFF is highlighted. This will cancel your ringback Listen to your handset for the Press the RED PHONE button To adjust the handset ringer You can choose from 5 levels Press the MENU options button. Use the DOWN button to Press the OK button. To adjust the handset ringer Press the DOWN button to You hear the current volume Press the OK button to confirm. SAVED is displayed. Press the DOWN button to Press the DOWN button to Press the OK button. You hear the current melody Press the DOWN button to To adjust the earpiece volume. There are 3 volume levels to Press the DOWN button to You hear the current volume Select the required level. Press OK to confirm. SAVED is Press the RED PHONE button To switch autotalk off To reset your handset to the The display shows RESET. Press the MENU options button. Press OK to confirm. This will reset. Earpiece volume 1. If autotalk is switched on you GREEN PHONE button to Redial list GREEN PHONE button to This will not delete the The default setting for autotalk Handset PIN. This will not reset. Registration to the base station. Press the MENU options button.

You can lock the keypad so that it cannot To switch keyguard on To switch keyguard off, press. You hear a confirmation NOT be dialled. If you experience any difficulties Base station PIN Personal Identification Number Your base station PIN has a default If you change your PIN keep a record To adjust the base ringer volume. Press the MENU options button. Press the OK button. Display shows AUDIO SET UP. Press the OK button. Press the DOWN button until Press the OK button. Display Enter your new 4 digit PIN Press the OK button. You hear Press the DOWN button to Enter your new 4 digit PIN. Press the OK button. Enter current PIN original To change the base station PIN Press the RED PHONE button There are 10 melodies to Press the DOWN button to Press the MENU options button. Press the DOWN button to Press the MENU options button. Press the DOWN button to Press the DOWN button to Enter your 4 digit PIN Display shows RESET. RESET is displayed. Press the DOWN button to This will reset. Alarm clock SAVED is displayed. Dialling mode Pause after picking It will delete the Calls list. If you experience any difficulties The base station PIN. Handset registration settings. Using the answering The answering machine is operated There is also a loudspeaker on your. Diverse 4016 Classic which gives you the To switch the answering Press the DOWN button until Press the OK options button. Your answering machine can be used Diverse 4016 as it has a prerecorded A confirms the answering You must set the time and date so that Caller Display service, the date and The factory setting for the Diverse Press the DOWN button until Press the RED PHONE button When the answering machine To record your own outgoing Your outgoing message is the A typical outgoing message Please note. The maximum outgoing message If you pause during recording for To play your outgoing message The display will show PLAYBACK. ANC and your recording will be To cancel recording, press the. RED PHONE button.

Press the DOWN button until Press the DOWN button until Press the OK options button. Put the handset to your ear The display shows REC ANC. Press the OK options button. Press the DOWN button until If you have the loudspeaker Or. Put the handset to your ear To delete your outgoing If you delete your own outgoing Press the DOWN button until To use call screening A indicates call screening is Press the OK options button Press the OK options button. The disappears. The display shows DELETED Pressing the OK options button Press the OK options button. Press the DOWN button until Press the DOWN button until Press the DOWN button until Press the OK options button. Press the DOWN button until Press the RED PHONE button If a caller is leaving a message, While the caller is leaving their Press the GREEN PHONE New message indicator In use light and the Shortcut to your messages Answering machine operation Press the LEFT button to repeat Press the LEFT button

twicePress the RIGHT button to playPlaying messages. To listen to your messages. Press the ENVELOPE optionsPut the handset to your earPlayback begins with the lastPress the Delete optionsPress the RED PHONE buttonHelpline. If you experience any dif ficultiesThe display will show SAVEDAdditional answeringPress the RED PHONE buttonTo set the number of rings. You can set how many timesTo adjust the message length. You can specify the time limitTime saver is the factoryPress the DOWN button untilPress the UP or DOWN buttonPress the OK options button.

<http://www.drupalitalia.org/node/70670>